

- NOTES:**
- PARCEL AREA: 1,487,644 SQ. FT. = 34.14 ACRES
  - NHDES SUBDIVISION APPROVAL NUMBER: sa2002003712
  - NHDES DREDGE & FILL APPROVAL NUMBER: 2001-02490
  - NHDES SITE SPECIFIC APPROVAL NUMBER: WPS-5240 (JULY 11, 2002)
  - NHDES WELL APPROVAL NUMBER: 993704 - HADLEIGH WOODS
  - PREVIOUS NHDES CONSTRUCTION APPROVAL NUMBER: CA2003049694
  - THE MAJORITY OF THE SUBJECT PROPERTY LIES WITHIN THE 140 SCS SOILS GROUP AS SHOWN ON THE SCS MAP FOR THE TOWN OF WINDHAM, NH.
  - 140 - CHATFIELD-HOLLIS-CANTON COMPLEX
  - SYSTEM LOADING CALCULATION
  - TOTAL NUMBER OF UNITS = 2
  - TOTAL NUMBER OF PROPOSED BEDROOMS = (2 BDRMS/UNITS) 4 TOTAL
  - 4 BEDROOMS X 150 GPD/BEDRM = 600 GPD
  - PERCOLATION RATE: 10 MIN./INCH 32"
  - NHDES MINIMUM LEACHING FIELD SIZE REQUIRED = 1,100 SQ. FT.
  - ELJEN (TYPE "B") IN-DRAIN CALCULATION
  - $3.5 + [(10 \text{ MIN./INCH} \times 0.125)] \times 4 \text{ BDRMS} = 19 \text{ UNITS}$
  - USE (21) TYPE "B" ELJEN IN-DRAIN UNITS, DISTRIBUTED LOCALLY BY HUBER DESIGN, INC. P.O. BOX 401, 175 PETERBOROUGH ROAD HANCOCK, NEW HAMPSHIRE 03449, PHONE: (603) 525-4320 OR APPROVED EQUAL.
  - SEPTIC TANK: USE (1) 2,000 GALLON 2-COMPARTMENT PRECAST CONCRETE SEPTIC TANK, AS MANUFACTURED AND DISTRIBUTED BY NEW ENGLAND PRECAST CORP., ROUTE 110 - AMESBURY, MASS. 01913
  - PHONE: (800) 323-9487, OR APPROVED EQUAL.
  - DISTRIBUTION BOX: USE (1) 3 OUTLET PRECAST CONCRETE DISTRIBUTION BOX AS MANUFACTURED AND DISTRIBUTED BY ROTONDO & SONS, INC., OR APPROVED EQUAL.
  - ALL PIPES EXITING THE PROPOSED DISTRIBUTION BOX SHALL HAVE AN "EQUALIZER" FLOW DIVIDER INSTALLED (OR APPROVED EQUAL). "EQUALIZER" FLOW DIVIDERS ARE DISTRIBUTED LOCALLY BY HUBER DESIGN, INC.
  - INSTALL A ZABEL, MODEL A300, FILTER, OR APPROVED EQUAL, AT THE OUTLET OF THE PROPOSED SEPTIC TANK. ZABEL FILTERS DISTRIBUTED BY ZABEL ENVIRONMENTAL TECHNOLOGY 10409 WATTERSON TR. LOUISVILLE, KY 40299-3701, PHONE: (800) 221-5742.
  - DESIGN INTENT: BOTTOM OF THE PROPOSED LEACHING FIELD SHALL BE 1.5 FEET ABOVE THE EXISTING GRADE ON THE UPSLOPE SIDE.
  - NEAREST GROUP 6 SOIL OR NEIGHBORING WELL ARE ALL GREATER THAN 100 FEET AWAY FROM THE PROPOSED SEPTIC SYSTEM.
  - PIPES LEADING TO AND EXITING FROM THE PROPOSED SEPTIC TANK AND DISTRIBUTION BOX SHALL BE SEALED WITH AN APPROVED METHOD AS TO MAKE THE JOINTS WATERTIGHT.
  - SHOULD FAILURE OCCUR THIS SYSTEM SHALL BE REBUILT IN-PLACE.
  - PIPES LEADING TO AND EXITING FROM THE PROPOSED SEPTIC TANK, PUMP CHAMBER AND DISTRIBUTION BOX SHALL BE SEALED WITH AN APPROVED METHOD AS TO MAKE THE JOINTS WATERTIGHT.
  - PRIOR TO THE START OF CONSTRUCTION ALL BENCHMARKS SHALL BE VERIFIED FOR ACCURACY.
  - FOUNDATION DRAINS: NO FOUNDATION DRAINS SHALL BE INSTALLED WITHIN 25 FEET OF THE PROPOSED SEPTIC SYSTEM OR WITHIN 10 FEET OF THE PROPOSED SEPTIC TANK.
  - NO GARBAGE DISPOSAL IS PROPOSED WITH THIS DESIGN.
  - INSTALLATION OF THE ELJEN IN-DRAIN SYSTEM SHALL BE IN STRICT ACCORDANCE WITH THE ELJEN IN-DRAIN DESIGN AND INSTALLATION MANUAL FOR THE STATE OF NEW HAMPSHIRE, REVISED JUNE 05, 1995.
  - JOINTS ARE TO BE BELLED PVC OR STANDARD SLIP COLLARS.
  - ALL LATERALS TO EXIT THE DISTRIBUTION BOX AT SAME ELEVATION.
  - 2' OF COVER SHALL BE PROVIDED OVER THE FIELD WHERE MOTOR VEHICLE TRAFFIC WILL PASS OVER THE SEPTIC SYSTEM FIELD. FILL SHALL NOT BE OF SATURATED SOIL.
  - ALL TREES, TOPSOIL, ROOTS, AND ORGANIC MATTER MUST BE REMOVED FROM THE AREA TO BE FILLED, OUT TO AND INCLUDING THE AREA UNDER THE IMPERMEABLE SOIL BARRIER. FILL MATERIAL TO BE CLEAN MEDIUM TO COARSE SAND, FREE OF TOPSOIL, HUMUS, DREDDINGS, OR STONES OVER 6" IN DIMENSION.
  - PROVIDE MEASURED TIES TO OWNER, ON THE LOCATION OF SEPTIC TANK ACCESS POINTS.
  - ANY DISCREPANCIES OR UNUSUAL CONDITIONS SHALL BE REPORTED TO THE DESIGNER BEFORE CONTINUING WITH THE INSTALLATION.

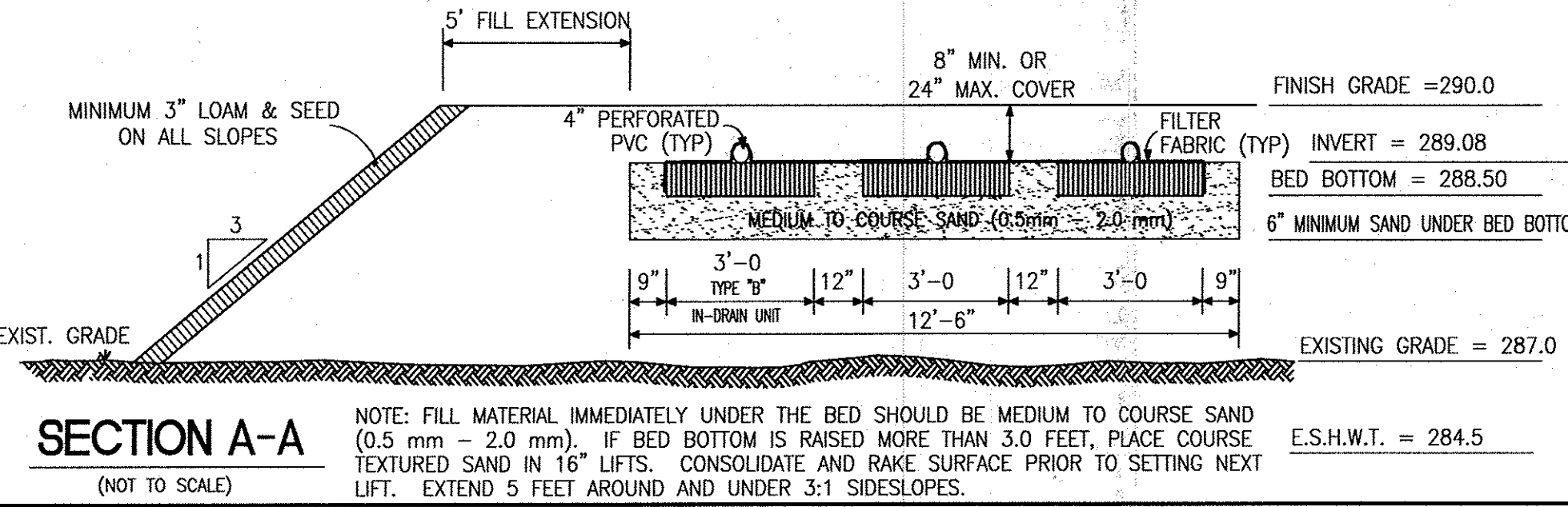

**TEST PIT "X"**  
(CONDUCTED ON NOVEMBER 15, 2001)

0-3" TOPSOIL (10YR 3/2) VERY DARK GRAYISH BROWN, TOPSOIL, FINE LOAMY SAND, GRANULAR, FRIABLE.

3"-32" (10YR 5/6) YELLOWISH BROWN FINE LOAMY SAND GRANULAR, FRIABLE.

32"-56" (10YR 6/4) LIGHT YELLOWISH BROWN FINE SAND, GRANULAR, FRIABLE.

E.S.H.W.T.: @ 32"  
NO WATER OBSERVED  
REFUSAL: @ 56"  
RESTRICTIVE LAYERS: NONE ENCOUNTERED  
PERC. RATE: 8 MIN./INCH @ 34"

**TEST PIT "Y"**  
(CONDUCTED ON NOVEMBER 15, 2001)

0-5" TOPSOIL (10YR 3/3) DARK BROWN FINE LOAMY SAND, GRANULAR, FRIABLE.

5"-24" (10YR 4/6) DARK YELLOWISH BROWN FINE LOAMY SAND GRANULAR, FRIABLE.

24"-48" (10YR 6/4) LIGHT YELLOWISH BROWN FINE SAND, GRANULAR, FRIABLE.

E.S.H.W.T.: @ 24"  
NO WATER OBSERVED  
REFUSAL: @ 48"  
RESTRICTIVE LAYERS: NONE ENCOUNTERED  
PERC. RATE: 10 MIN./INCH @ 32"

**TEST PIT "34/36"**  
(CONDUCTED ON MARCH 20, 2003)

0-3" TOPSOIL (10YR 3/3) DARK BROWN FINE LOAMY SAND, GRANULAR, FRIABLE.

3"-32" (10YR 4/6) DARK YELLOWISH BROWN FINE LOAMY SAND GRANULAR, FRIABLE.

32"-36" (10YR 6/4) LIGHT YELLOWISH BROWN FINE SAND, GRANULAR, FRIABLE.

E.S.H.W.T.: @ 30"  
NO WATER OBSERVED  
REFUSAL: @ 32"  
RESTRICTIVE LAYERS: NONE ENCOUNTERED  
PERC. RATE: 10 MIN./INCH @ 32"

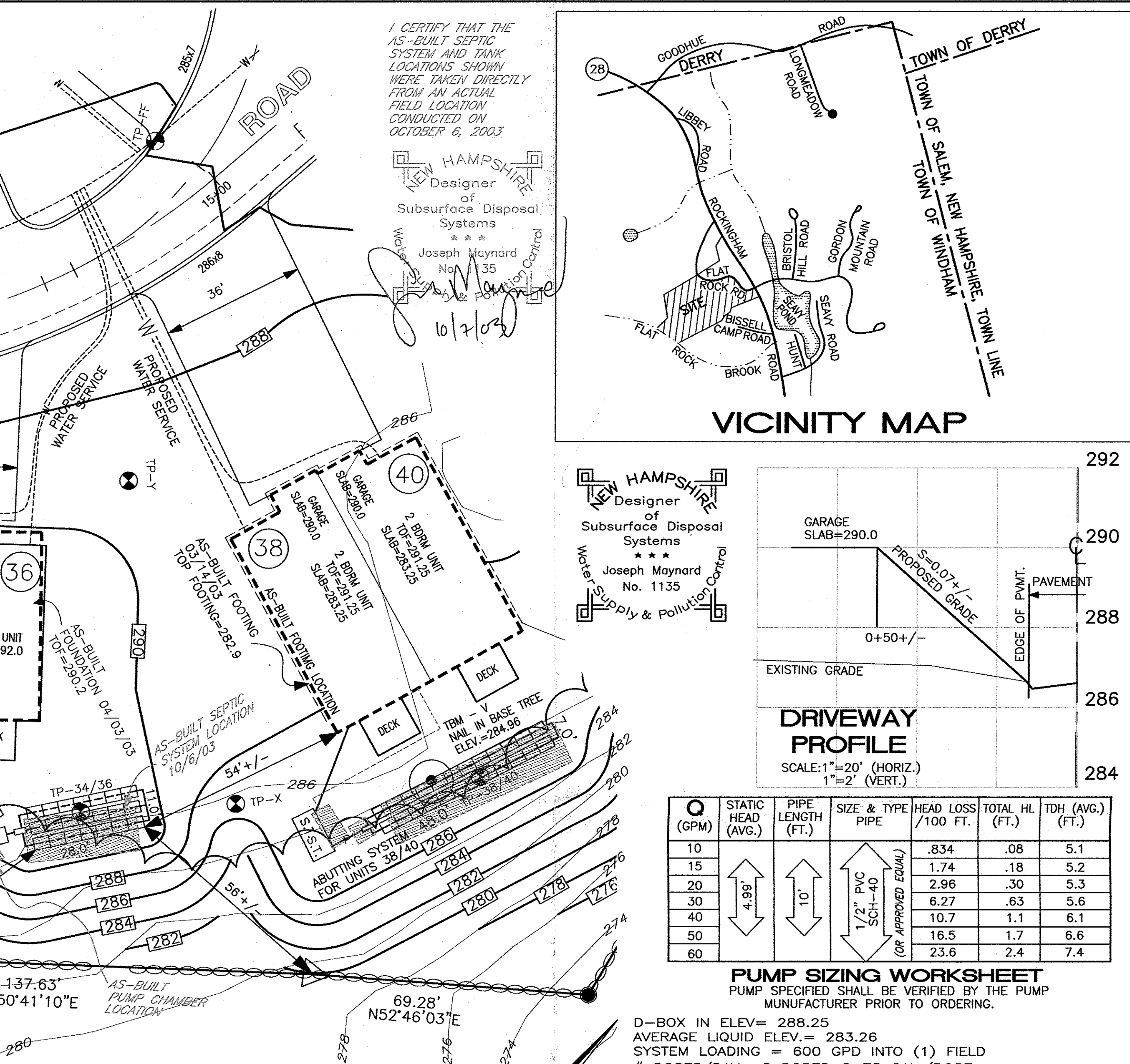
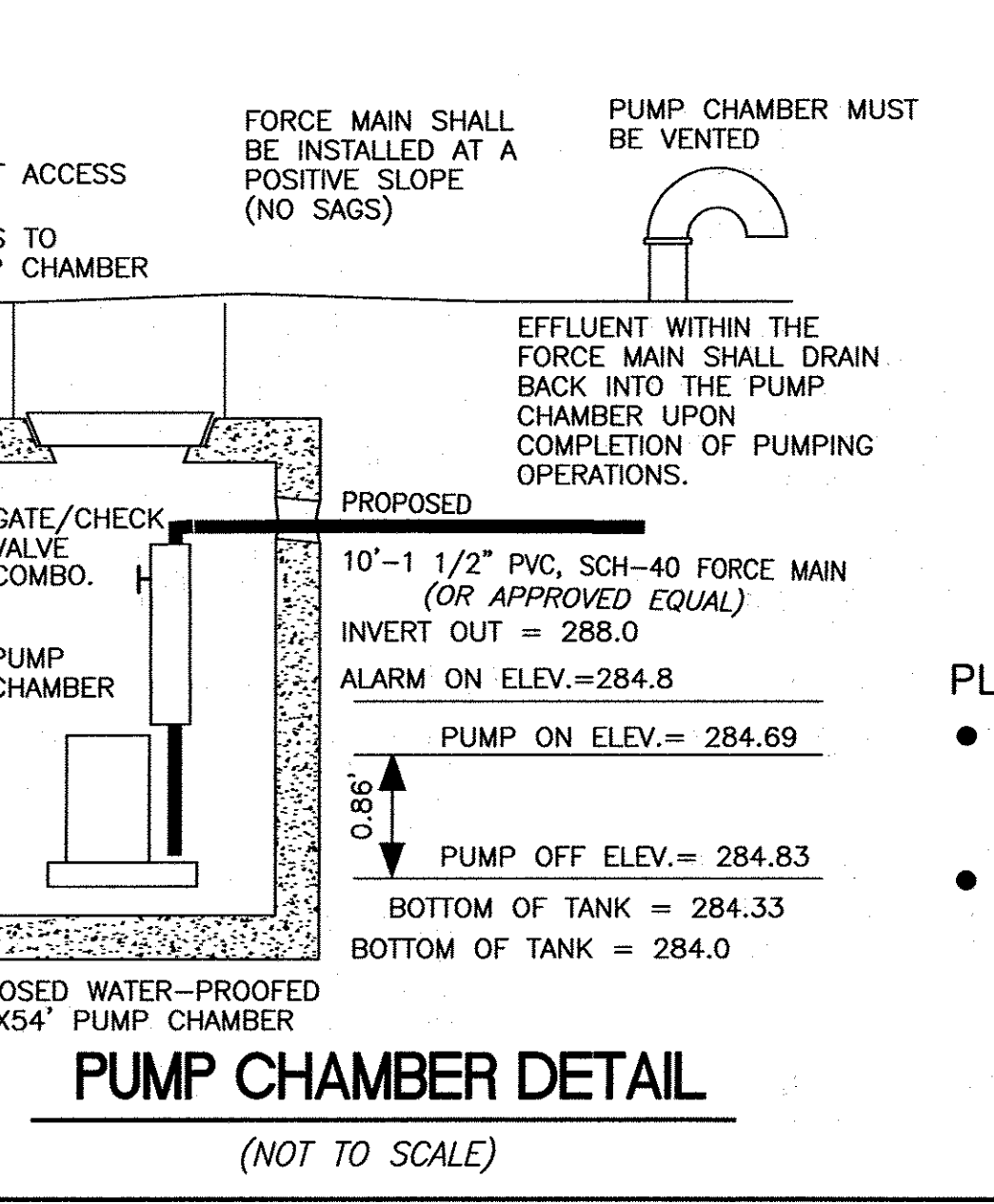

- PUMP NOTES:**
- PUMP CHAMBER: USE (1) 4'X4'X4' PRECAST CONCRETE PUMP CHAMBER AS MANUFACTURED AND DISTRIBUTED BY NEW ENGLAND PRECAST CORP. 126 OLD TURNPIKE ROAD, BARRINGTON, NEW HAMPSHIRE. PHONE: (603) 942-5600, OR APPROVED EQUAL.
  - FORCE MAIN: EXISTING FORCE MAIN LOCATION SHOWN IS APPROXIMATE ONLY. ACTUAL LOCATION AND CONDITION OF EXISTING FORCE MAIN SHALL BE INSPECTED BY THE INSTALLER PRIOR TO THE START OF CONSTRUCTION. FORCE MAIN SHALL BE INSTALLED AT A POSITIVE SLOPE, NO SAGS. FORCE MAIN SHALL BE 1 1/2" PVC, SCH-40. EFFLUENT WITHIN THE FORCE MAIN SHALL DRAIN BACK INTO THE PUMP CHAMBER UPON COMPLETION OF PUMPING OPERATIONS.
  - A VELOCITY REDUCTION DEVICE, SUCH AS A PIPE "T", SHALL BE INSTALLED AT THE END OF THE PROPOSED FORCE MAIN WITHIN THE PROPOSED D-BOX.
  - PROPOSED PUMP: USE (1) MYERS PUMP, MODEL WHRE-5, CAPABLE OF PUMPING 56 GPM @ TDH OF 7.5' WITH A 4/10 HP MOTOR, MYERS PUMPS DISTRIBUTED LOCALLY BY AETNA PUMPS ROUTE 29 - ALTON, NEW HAMPSHIRE - PHONE: 1-800-552-0389 APPROVED EQUAL.
  - ALARM AND CONTROL PANEL: FLOATING SWITCHES, CONTROL PANEL AND ALARM ARE TO BE SPECIFIED BY THE MANUFACTURER. ALARM AND CONTROL PANEL ARE TO BE MOUNTED WITHIN THE PROPOSED HOUSE.
  - PROPOSED PUMP SPECIFIED SHALL BE VERIFIED BY THE PUMP MANUFACTURER.
- PLAN REFERENCES:**
- SEE PLANS TITLED "SITE PLANS TAX MAP 3-B LOT 265 HADLEIGH WOODS WINDHAM, NEW HAMPSHIRE" OWNER: LOT 3-B-200 & 3-B-265 ADDRESS: 8 DEERWOOD HOLLOW CHESTER, NEW HAMPSHIRE 03036 SHEETS 1-15 OF 15 DATED MARCH 27, 2002 AS PREPARED BY THIS OFFICE.
  - SEE PLAN TITLED "SUBDIVISION PLAN TAX MAP 3-B LOT 200 & TAX MAP 3-B LOT 265 TAX MAP 3-B LOT 271 NH ROUTE 28 - ROCKINGHAM ROAD WINDHAM, NEW HAMPSHIRE 03087" OWNER: LOT 3-B-200 & LOT 3-B-265 H&B HOMES CORP. ADDRESS: 8 DEERWOOD HOLLOW CHESTER, NEW HAMPSHIRE 03036 OWNER: LOT 3-B-271 ANTHONY PETA ADDRESS: 30 BRANDYWINE COMMON DERRY, NEW HAMPSHIRE 03038 SHEETS 1-12 OF 12 DATED: MARCH 27, 2002 AS PREPARED BY THIS OFFICE.

**SEPTIC SYSTEM PLAN**  
**TAX MAP 3-B LOT 265**  
**UNITS 34/36 HADLEIGH ROAD**  
**WINDHAM, NEW HAMPSHIRE 03087**

OWNER OF RECORD/PREPARED FOR  
**H&B HOMES CORP.**  
8 DEERWOOD HOLLOW  
CHESTER, NEW HAMPSHIRE 03036  
R.C.R.D. BOOK 3575/PAGE 2759

SCALE: 1"=20' SHEET 1 OF 1 OCTOBER 10, 2002

Q (GPM)	STATIC HEAD (AVG.)	PIPE LENGTH (FT.)	SIZE & TYPE PIPE	HEAD LOSS /100 FT.	TOTAL HL (FT.)	TDH (AVG.) (FT.)
10	4.99'	10'	1 1/2" PVC SCH-40 (OR APPROVED EQUAL)	.834	.08	5.1
15				1.74	.18	5.2
20				2.96	.30	5.3
30				6.27	.63	5.6
40				10.7	1.1	6.1
50				16.5	1.7	6.6
60	23.6	2.4	7.4			

**PUMP SIZING WORKSHEET**  
PUMP SPECIFIED SHALL BE VERIFIED BY THE PUMP MANUFACTURER PRIOR TO ORDERING.

D-BOX IN ELEV= 288.25  
AVERAGE LIQUID ELEV= 283.26  
SYSTEM LOADING = 600 GPD INTO (1) FIELD  
# DOSES/DAY= 8 DOSES @ 75 GAL./DOSE  
PUMP CHAMBER USED: 4'X4'X4' CONC.  
WORKING DEPTH = 0.86'  
AREA = 87 GALLONS/FT.  
FORCE MAIN LENGTH = 175'  
PUMPING TIME/DOSE = 2.0 MINUTES  
PUMP. MANUFACTURER SHALL VERIFY PUMP PRIOR TO ORDERING

**REVISIONS:**

NO.	DATE	DESCRIPTION
1	10-6-03	AS-BUILT SEPTIC SYSTEM

**BENCHMARK ENGINEERING, INC.**  
Consulting Engineers Land Planners  
10 Commons Drive, Suite 17  
Londonderry, New Hampshire 03053  
Phone: (603) 437-5000  
Fax: (603) 437-3078

12